

NOTE:
 THE LOT NUMBER IS FOUND IN THE UPPER RIGHT
 HAND CORNER OF THE LOTS AS YOU FACE THE
 LOTS AND IS INDICATED THUS []

LOCATION OF GRAVE MARKERS SHOWN THUS
 ARROW INDICATES DIRECTION GRAVE MARKERS
 WILL FACE.

ALL LOTS ARE 2 GRAVE LOTS EXCEPT WHERE
 OTHERWISE NOTED.
 ALL 2 GRAVE LOTS ARE 6'x9'
 ALL 3 GRAVE LOTS ARE 9'x9'

1499 - 2 GRAVE LOTS
 82 - 3 GRAVE LOTS
 1562 - TOTAL LOTS

ALL SAINTS CEMETERY
 NORTHFIELD, OHIO
WEST PART
SECTION 8

REV. (A) 4-17-89
 REV. (C) 1-22-76
 SCALE 1" = 20' G.C.A. APRIL, 1963

Sec. 16

Sec. 17

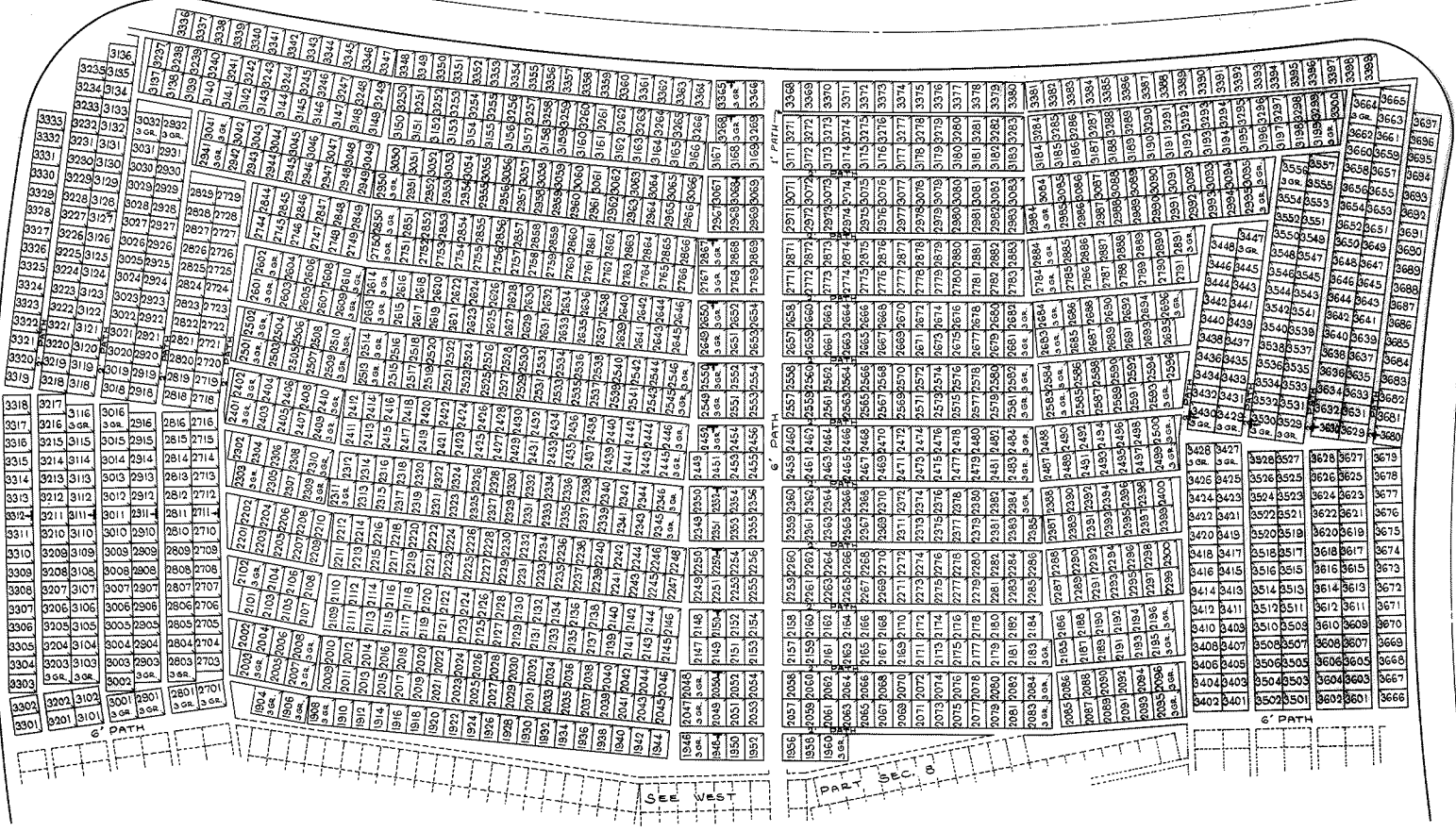

NOTE:
 THE LOT NUMBER IS FOUND IN THE UPPER RIGHT
 HAND CORNER OF THE LOTS AS YOU FACE THE LOTS
 AND IS INDICATED THUS \nearrow

LOCATION OF GRAVE MARKERS SHOWN THUS \blacktriangledown
 ARROW INDICATES DIRECTION GRAVE MARKERS
 WILL FACE.

LOTS 3368 THROUGH 3399 ARE RESERVED FOR
 ORDINARY DEPTH BURIALS ONLY.

ALL LOTS ARE 2 GRAVE LOTS EXCEPT WHERE
 OTHERWISE NOTED.

ALL 2 GRAVE LOTS ARE 6'x9'
 ALL 3 GRAVE LOTS ARE 9'x9'
 1395 2 GRAVE LOTS
 1487 3 GRAVE LOTS
 1487 TOTAL LOTS

ALL SAINTS CEMETERY
 NORTHFIELD, OHIO
EAST PART
SECTION 8
 SCALE 1"=20' G.C.A. APRIL, 1963

Sec. 7